

LightCell fuel cells

Part # Depending on size and CFC version, more information on page 2

Assembly Instructions | © Nuke Performance AB 2025

For more information visit : www.nukeperformance.com

- 1** CFC Unit - version depending on SKU *
Part # 150-05-203 / 150-05-204
- 2** 24 x stainless steel bolts and nylon washers, 1/4-28 UNF x 1
Part # 150-10-118
- 3** Viton gasket for 24 bolt pattern fuel cells
Part # 150-05-301
- 4** 16-22 x K6S M6x10 stainless steel bolts and M6 lock nuts **
Part # 150-05-300 / Thread size : 1/4-28 UNF x 1
- 5** Powder coated aluminum top lid
- 6** FIA homologation badge inspection window
Homologation information located on bladder beneath removable plate
- 7** Foam baffled, double coated urethane fabric bladder
Five year warranty and five year homologation
- 8** Powder coated aluminum bottom container

* 150-07-061 is delivered with Low profile CFC Unit
150-07-161 is delivered with CFC Unit for brushless fuel pumps
** Depending on fuel cell size

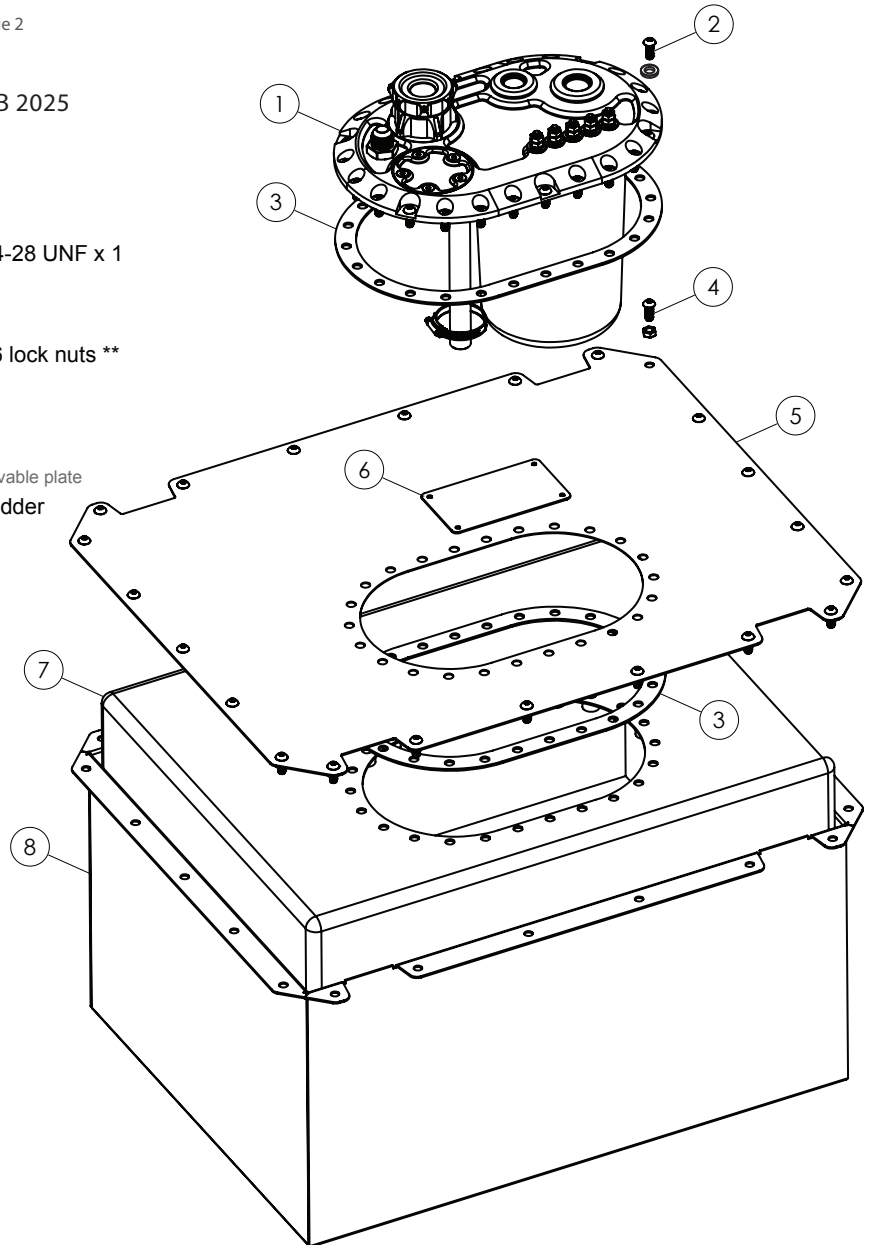

Nuke Performance LightCell fuel cell specifications

For more information about specifications, visit our product page on our website.

Nuke Performance : www.nukeperformance.com



Fuel capacity	25, 35, 45, 55 liter (≈ 7, 9, 12, 15 gallons)	Internal baffling	YES, full foam baffling
Fuel compatibility	Gasoline, Methanol, Ethanol, E85, E100	Container	Powder coated aluminum
For motorsports use	YES	Internal bladder	Ultra durable double coated urethane fabric
Homologation	YES, FIA/FT3 APPROVED	Fill plate thread pattern	6x10", 1/4-28 UNF, 24 bolt pattern

Nuke Performance CFC Unit - High Profile / Brushless specifications

For more information about specifications, visit our product page on our website.

Part numbers shown as: HP=High Profile CFC Unit / B=Brushless CFC Unit

Included CFC Unit Part #	HP:150-05-203 / B:150-05-204	Fits # H.P fuel pump	1 or 2 x in-tank fuel pumps
Mounting bolt pattern	6x10" 24-bolt pattern	Fuel compatibility	Gasoline, Methanol, Ethanol, E85, E100
Lift pump connectors	6mm x 2 (max 125 ampere / each)	Internal surge tank volume	Approximately 2.0 liter (0.53 gallons)
H.P pump connectors	6mm x 3 (max 125 ampere / each) *	Outlet port, thread	AN-10 ORB female thread
Length	295mm (13.74")	Return port, thread	AN-8 ORB female thread
Width	194mm (9.88")	Vent valve, thread	AN-8 (3/4 UNF) female thread
Weight	HP:2254g (4.96lb) / B:2290g (5.05lb)	Vent valve fitting included	AN-8 (3/4 UNF) to AN-6 Male
Fits # of lift fuel pumps	1 x in-tank fuel pump	For motorsports use	YES

* Depending on the selected CFC Unit version. For the brushless version, it uses a 6-pin bulkhead connector for the high-pressure fuel pumps.

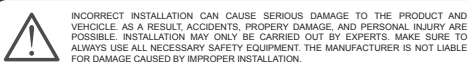

Information:

Design combined with top quality performance.
For more information about the products and retailers visit
www.nukeperformance.com

nuke
PERFORMANCE

Nuke Performance LightCell fuel cell measurements

For more information about specifications, visit our product page on our website.

LightCell 25 liter fuel cell

Part # : 1500-09-501 HP:150-09-025 / B:150-09-125

Capacity : 25 liter (≈7 gallons)

Measurements :

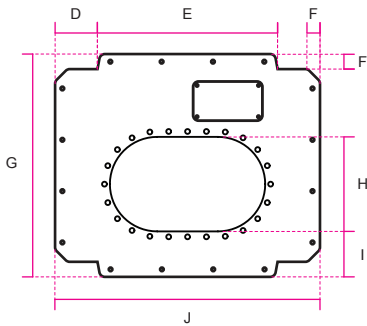
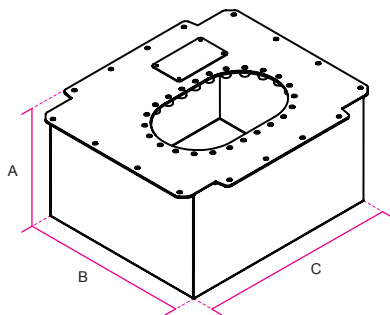

A	210mm (8.27")
B	335mm (13.19")
C	395mm (15.55")
D	70mm (2.76")
E	305mm (12.01")
F	25mm (0.98")
G	385mm (15.16")
H	159mm (6.26")
I	77mm (3.03")
J	445mm (17.52")

Weight 5420g (11.95lb) *
* without CFC Unit

LightCell 35 liter fuel cell

Part # : 1500-09-502 HP:150-09-035 / B:150-09-135

Capacity : 35 liter (≈9 gallons)

Measurements :

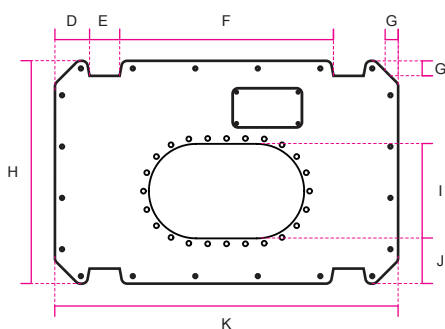
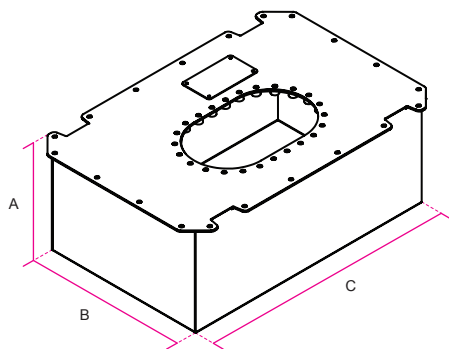

A	210mm (8.27")
B	335mm (13.19")
C	526mm (20.71")
D	59mm (2.32")
E	50mm (1.97")
F	358mm (14.09")
G	25mm (0.98")
H	385mm (15.16")
I	159mm (6.26")
J	77mm (3.03")
K	576mm (22.68")

Weight 6750g (14.88lb) *
* without CFC Unit

LightCell 45 liter fuel cell

Part # : 1500-09-503 HP:150-09-045 / B:150-09-145

Capacity : 45 liter (≈12 gallons)

Measurements :

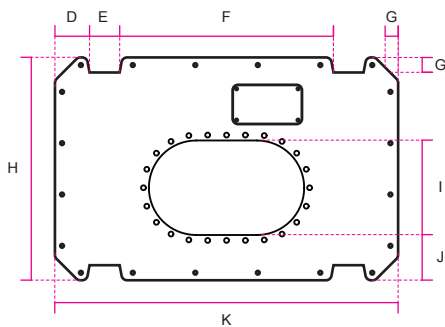
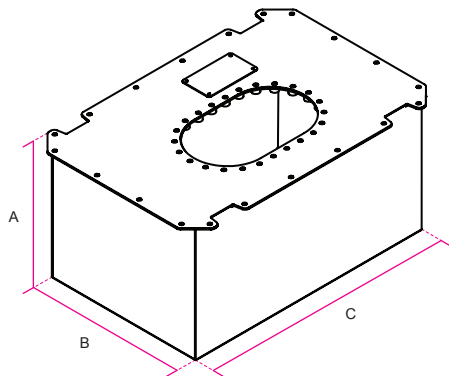

A	270mm (10.63")
B	335mm (13.19")
C	526mm (20.71")
D	59mm (2.32")
E	50mm (1.97")
F	358mm (14.09")
G	25mm (0.98")
H	455 (17.91")
I	159mm (6.26")
J	77mm (3.03")
K	576mm (22.68")

Weight 7450g (16.42lb) *
* without CFC Unit

LightCell 55 liter fuel cell

Part # : 1500-09-504 HP:150-09-055 / B:150-09-155

Capacity : 55 liter (≈15 gallons)

Measurements :

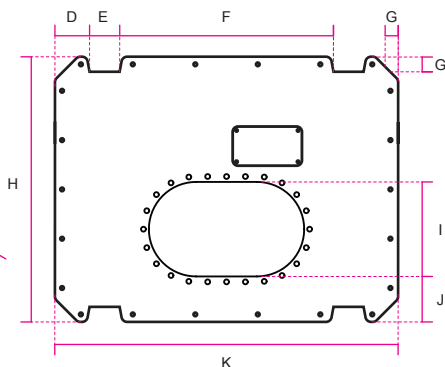
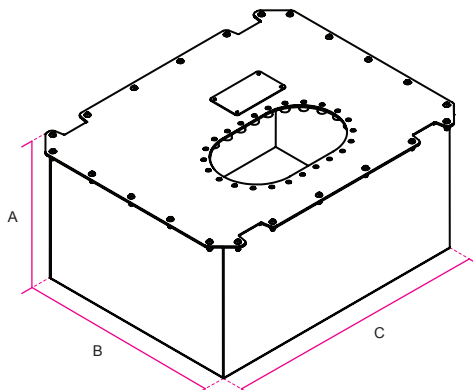

A	270mm (10.63")
B	405mm (15.94")
C	526mm (20.71")
D	59mm (2.32")
E	50mm (1.97")
F	358mm (14.09")
G	25mm (0.98")
H	385mm (15.16")
I	159mm (6.26")
J	77mm (3.03")
K	576mm (22.68")

Weight 8320g (18.34lb)
* without CFC Unit

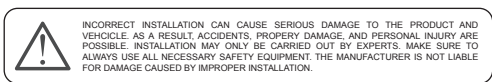

Information:

Design combined with top quality performance.
For more information about the products and retailers visit
www.nukeperformance.com

