

Vacuum Stations 3/4/5 outlets

Part # 600-01-201 / 600-01-202 / 600-01-203 / 600-01-204

Assembly Instructions | © Nuke Performance AB 2022

For more information visit : www.nukeperformance.com

- 1 Vacuum Station body, Part # 600-01-201
- 2 Vacuum Station Slim body, Part # 600-01-204
- 3 Vacuum Station Slim body, Part # 600-01-203
- 4 Vacuum Station Slim body, Part # 600-01-202
- 5 1/4 BSPP Pneufit Quick Connect to 6mm tubing
Part #: 300-10-103
- 6 1/4 BSPP Plug
Part #: 700-01-106

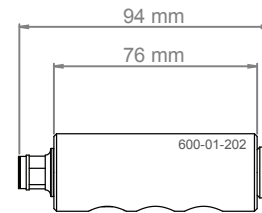
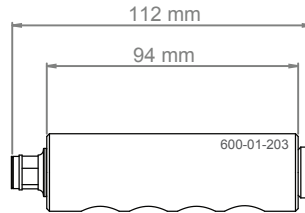
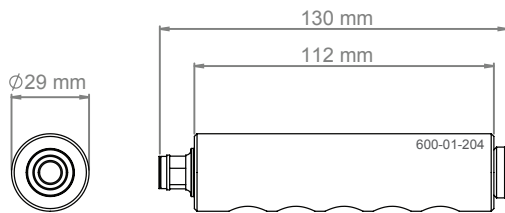
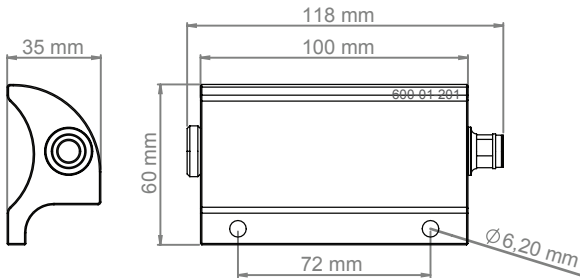
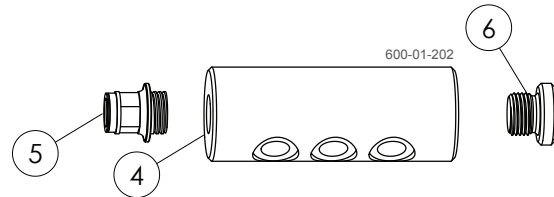
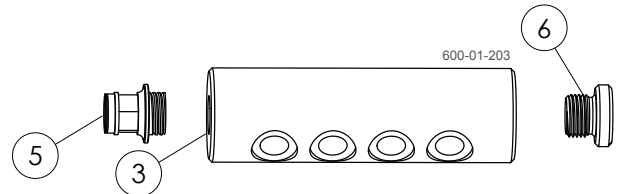
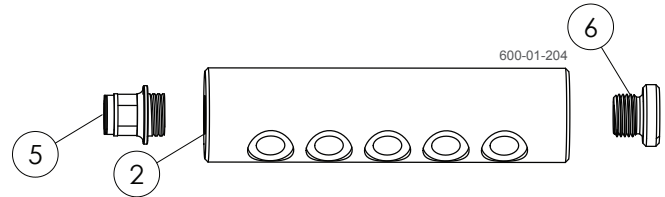
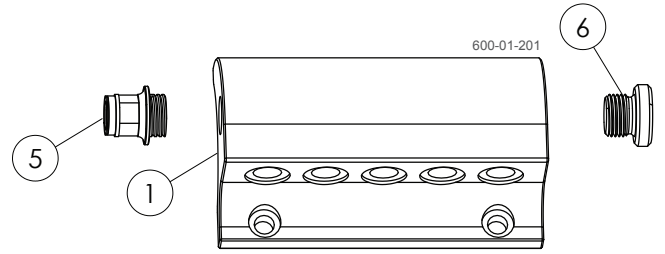

Nuke Performance Vacuum Station 5 outlets specifications :

For more information about specifications, visit our product page on our website.

Part #	600-01-201
Side port / thread	2 x 1/4 BSPP
Outlet port / thread	5 x 1/8 BSPP
Integrated bracket	YES
Length	100 mm (3.93")
Height	60 mm (2.36")
Depth	35 mm (1.38")
Weight	303 g (0.67lb)

Nuke Performance Vacuum Station Slim 3 outlets specifications :

For more information about specifications, visit our product page on our website.

Part #	600-01-202
Side port / thread	2 x 1/4 BSPP
Outlet port / thread	3 x 1/8 BSPP
Integrated bracket	NO
Length	76 mm (2.99")
Height	29 mm (1.14")
Depth	29 mm (1.14")
Weight	140 g (0.31lb)

Nuke Performance Vacuum Station Slim 4 outlets specifications :

For more information about specifications, visit our product page on our website.

Part #	600-01-203
Side port / thread	2 x 1/4 BSPP
Outlet port / thread	4 x 1/8 BSPP
Integrated bracket	NO
Length	94 mm (3.70")
Height	29 mm (1.14")
Depth	29 mm (1.14")
Weight	170 g (0.37lb)

Nuke Performance Vacuum Station Slim 5 outlets specifications :

For more information about specifications, visit our product page on our website.

Part #	600-01-204
Side port / thread	2 x 1/4 BSPP
Outlet port / thread	5 x 1/8 BSPP
Integrated bracket	NO
Length	112 mm (4.41")
Height	29 mm (1.14")
Depth	29 mm (1.14")
Weight	195 g (0.43lb)



INCORRECT INSTALLATION CAN CAUSE SERIOUS DAMAGE TO THE PRODUCT AND VEHICLE. AS A RESULT, ACCIDENTS, PROPERTY DAMAGE, AND PERSONAL INJURY ARE POSSIBLE. INSTALLATION MAY ONLY BE CARRIED OUT BY EXPERTS. MAKE SURE TO ALWAYS USE ALL NECESSARY SAFETY EQUIPMENT. THE MANUFACTURER IS NOT LIABLE FOR DAMAGE CAUSED BY IMPROPER INSTALLATION.



Information:

Design combined with top quality performance.
For more information about the products and retailers visit www.nukeperformance.com

